

Crown series



YOKINS Crown Series is designed for Flush panel mounting arrangement. In Crown series meters are manufactured in Moving coil, Moving iron and moving coil rectifier type.

Features:

- AC Moving Iron type for ACF65 and ACF80
- DC Moving Coil type for DCF65, DCF80, DCF100
- AC Moving coil type with Rectifier Circuit in all above model

Accuracy : $\pm 1.5\%$ of Full Scale for DCF80 and DCF100.

$\pm 2.5\%$ of Full Scale for ACF65, DCF65 & ACF80.

Standards : IS-1248

Size : Dimensional details below.

Type	PanelCut	A	B	C	D	E	Scale Length
ACF/DCF 65	55	46	46	35	65	65	60
ACF/DCF 80	64	63	54	40	80	80	72
DCF 100	65	83	50	38	100	80	90
DCF 120	70	102	55	40	120	100	105

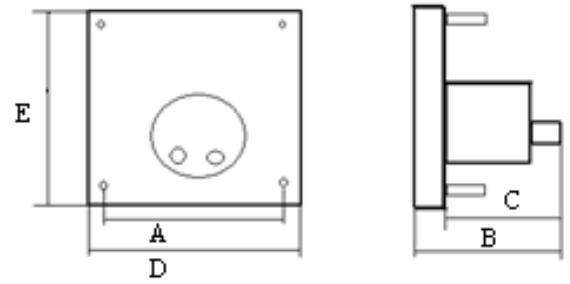

Application :

- Marine
- X-ray machine
- Switchgear
- Distribution systems
- Control panels
- Embedded generation
- Energy management
- Building management
- Utility power monitoring
- Process Control
- Motor Monitoring